

MASTERBUILT®

Hopper Heat Shield Instruction Sheet

Gravity Fed Grill CGP24G1D, CGP28G1D, CGP30G1D



CAUTION



- Always remove plug from outlet before servicing your grill.
- Make sure your grill has fully cooled to avoid burns.
- Some components may have sharp edges. Use caution to avoid injury.

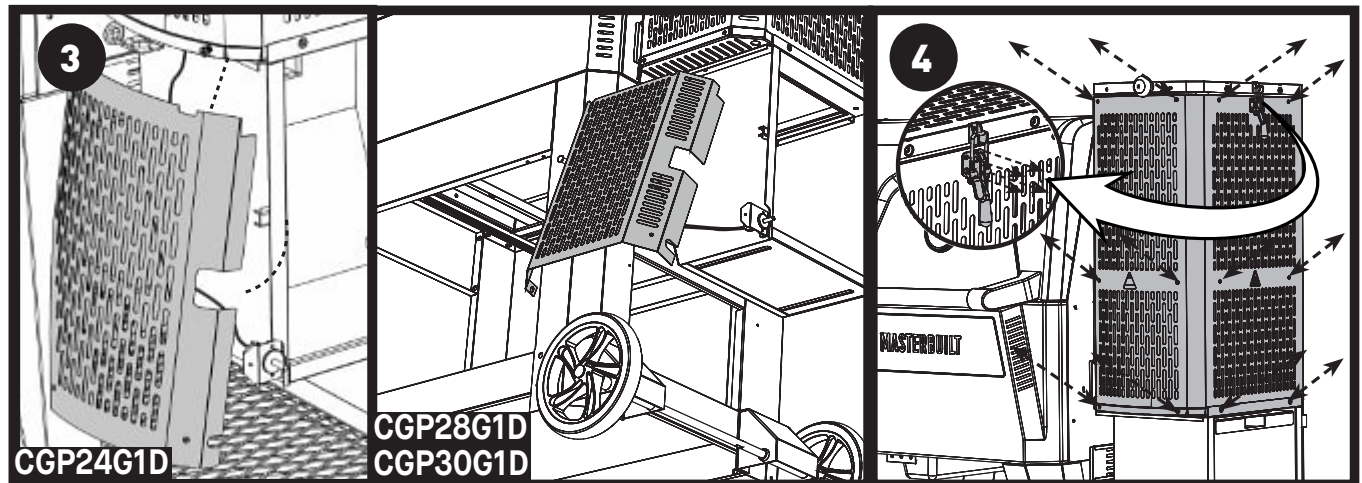
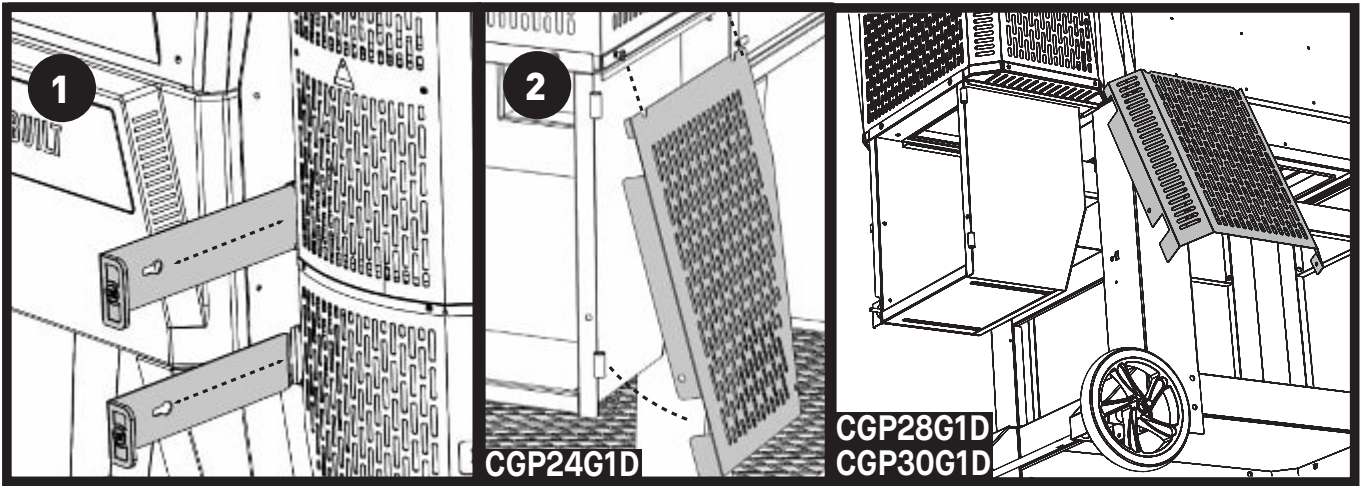

REMOVAL:

- Turn the grill off.
- Unplug the grill from any power source.
- Remove the intake slides (Figure 1).
- Loosen the top heat shield screws on the bottom of the hopper and remove the lower screws in order to remove the bottom's heat shields. (Figures 2 and 3).
- Loosen the remaining screws on the heat shields on the main body of the hopper to remove them as well (Figure 4).

INSTALLATION:

- Confirm the grill is powered off and not plugged into a power source.
- Secure the protective heat shield in place on the top and middle sections of the hopper (Figure 4), leaving the bottom screws loose.
- Slide the bottom heat shield UNDER the top heat shield (outer flange fits BEHIND the rim of the hopper opening) (Figure 3).
- Install the lower screws on the bottom heat shield and then tighten the top screws again.
- Repeat with the heat shields on the back of the hopper (Figure 2).
- Insert the intake slides (Figure 1).