

KJ15041123/KJ15041523
KAMADOJOE®
Konnected Joe™
Rear Module

CAUTION - SAFETY PRECAUTIONS - READ BEFORE USE

- Make sure your grill has fully cooled before handling to avoid burns.
- Some components may have sharp edges. Use caution to avoid injury.
- Disconnect the power supply from the grill before handling.



Unplug lid switch, pit probe, and power supply.



Loosen two screws from rear module. Please note, the screws do not have to be fully removed to disengage the rear module.

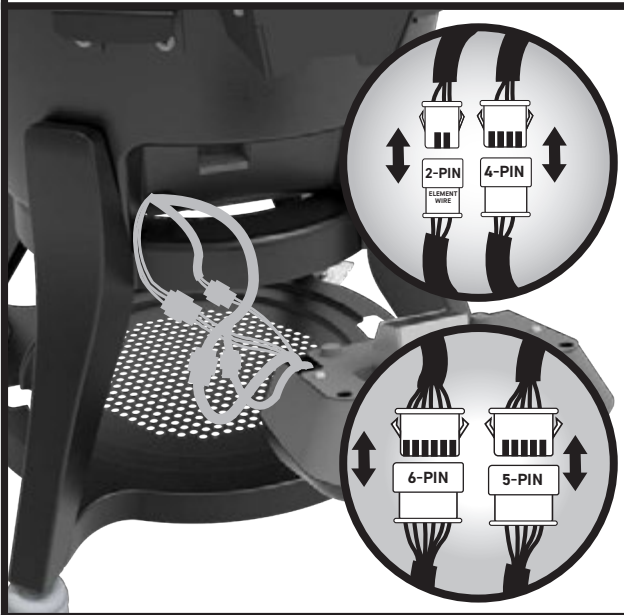

Disconnect the wire harness from the rear module. Use caution do not apply tension on the wire harness.



Repeat the steps in reverse order to install the new rear module. *Note - when reinstalling the rear module, be sure the fan tube is fully seated in the grill body.