

KJ15042525/KJ15042425

KAMADOJOE[®]

Konnected Joe[™]

Wire Harness



CAUTION - SAFETY PRECAUTIONS - READ BEFORE USE



- Make sure your grill has fully cooled before handling to avoid burns.
- Some components may have sharp edges. Use caution to avoid injury.
- Disconnect the power supply from the grill before handling.

Pictures are for illustration purposes only.



Unplug lid switch, pit probe, and power supply.



Remove two screws from front module.



Remove front module.



Disconnect the wire harness from the front module. Use caution do not apply tension on the wire harness.

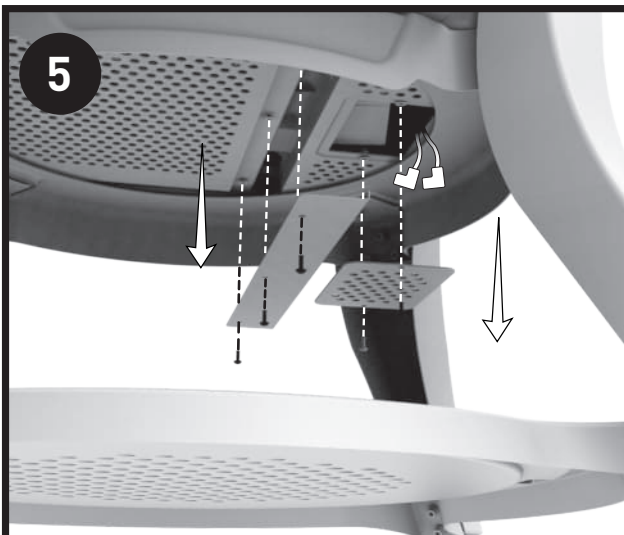

Remove access panels and separate the element from the element plugs.



Loosen two screws from rear module. Please note, the screws do not have to be fully removed to disengage the rear module.

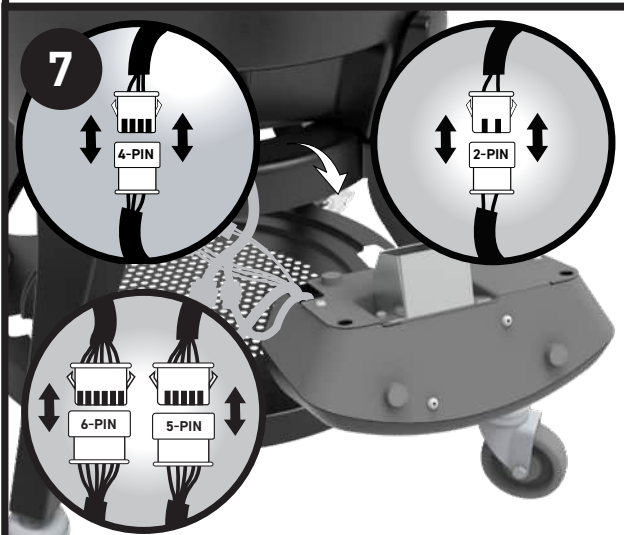

Disconnect the wire harness from the rear module. Remove the old wire harness. Fish through the pass through hole at the bottom of the base. Use caution do not apply tension on the wire harness.



Fish the new wire harness through the front pass through hole.

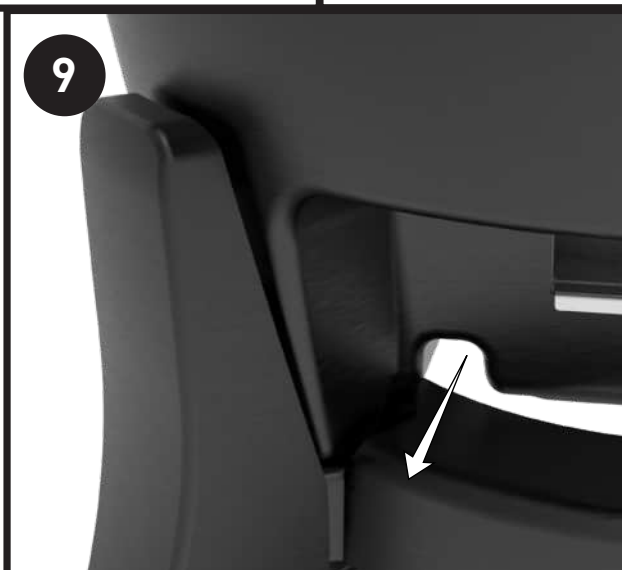

Fish the new wire harness through the rear pass through hole.

Repeat the steps in reverse order to install the new wire harness.