

KJ15042525/KJ15042425

KAMADOJOE®

Konnected Joe™

Black Base



CAUTION - SAFETY PRECAUTIONS - READ BEFORE USE



- Make sure your grill has fully cooled before handling to avoid burns.
- Some components may have sharp edges. Use caution to avoid injury.
- Disconnect the power supply from the grill before handling.

Pictures are for illustration purposes only.

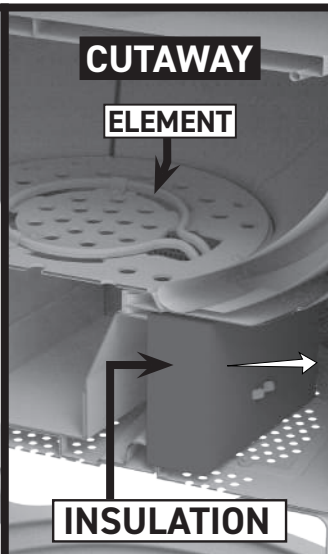
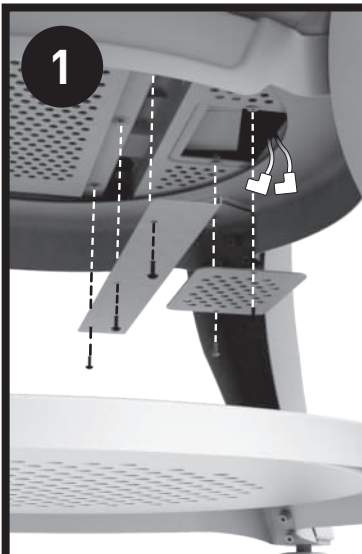

Remove access panels and separate the element from the element plugs. Note: Move the insulation to the side. The insulation should stay inside the grill. It will be reused.

Remove cooking grate, heat deflector and flexible cooking rack from grill.

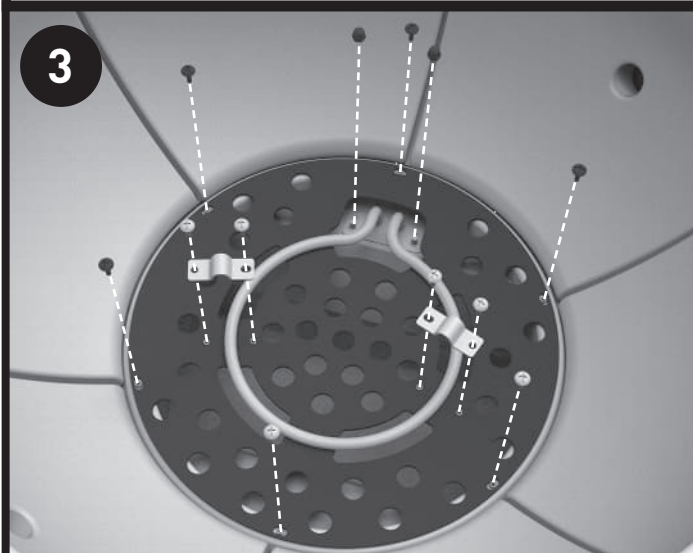

Remove the 2 nuts and 10 screws from the element mounting plate. Remove the 2 brackets.

Remove the element from the grill.
Note: You will need to turn the element sideways to clear the element mounting plate.

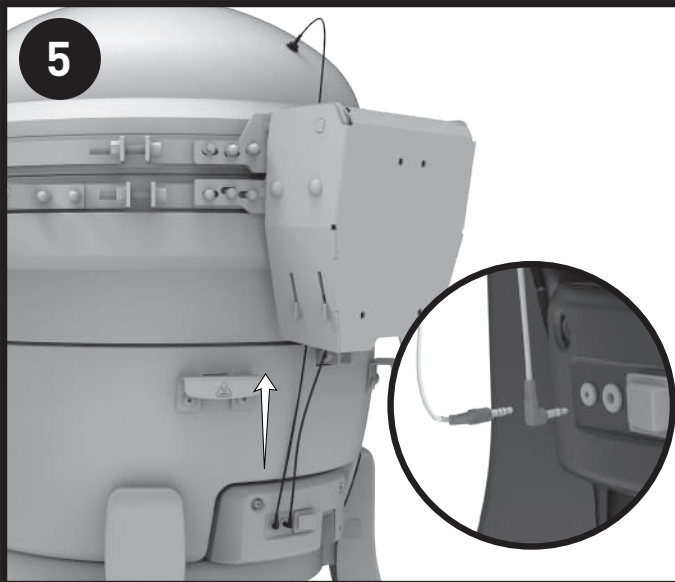

Unplug the pit probe, lid switch, and power supply. from the rear of grill. Thread the pit probe and lid switch through the hinge.

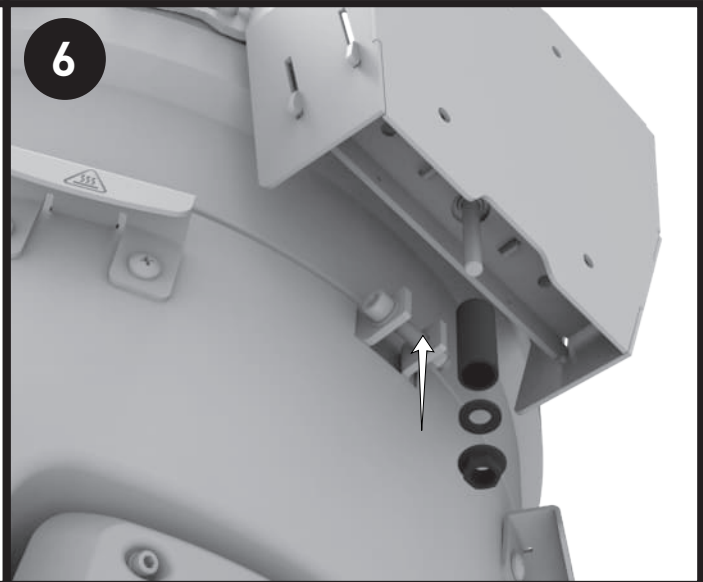

Install the disengagement tool on the hinge.

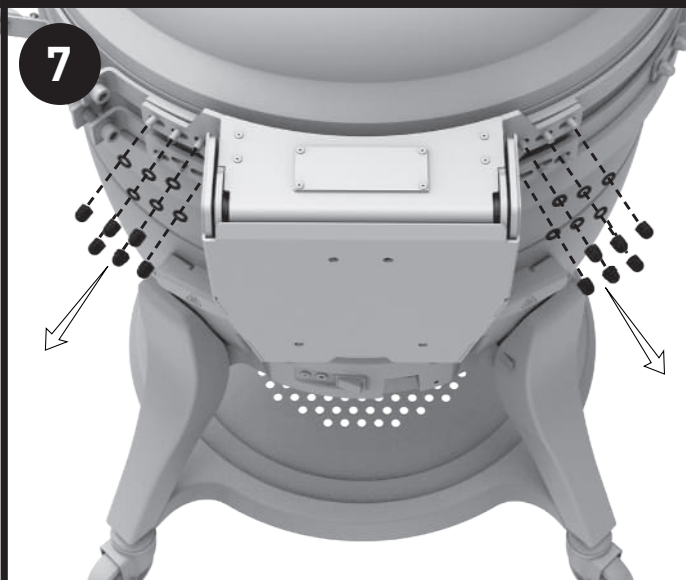

Remove 12 hinge acorn nuts and 12 washers.

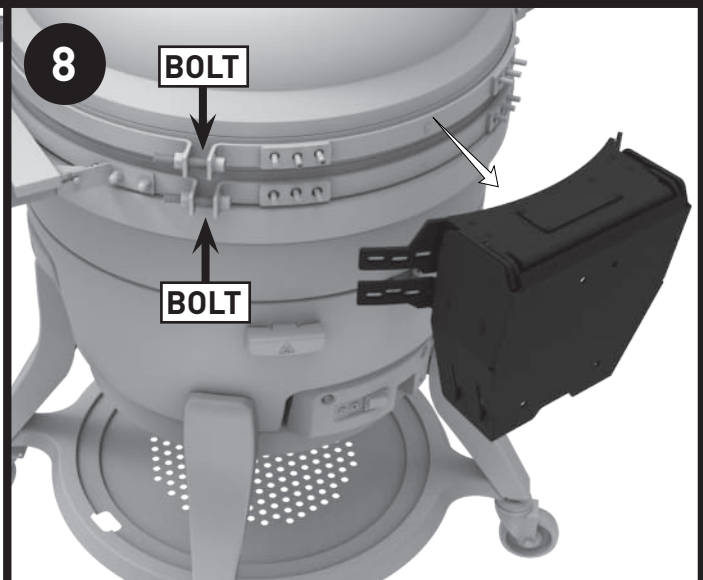

Remove the hinge. Remove the lid and set aside. Note: You can loosen the bolt on the upper and lower bands if the hinge will not disengage.

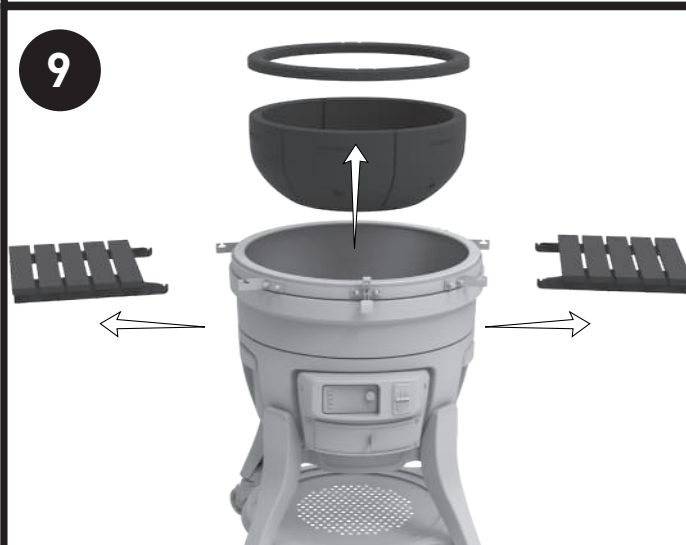

Remove the fire box assembly and side shelves.



Remove the ceramic ring from the grill.



Remove the lower band and stainless steel fire bowl.

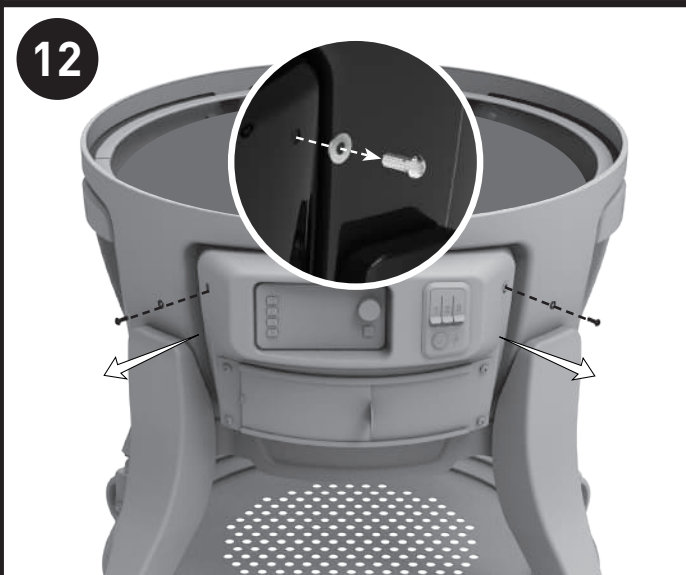

Remove two screws from front module.



Remove the front module.

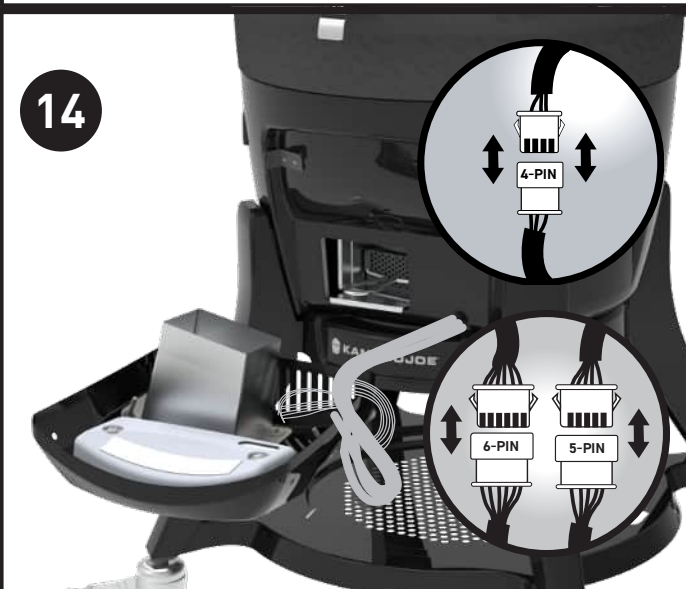

Disconnect the wire harness from the front module. Use caution do not apply tension on the wire harness.



Loosen two screws from rear module. Please note, the screws do not have to be fully removed to disengage the rear module.

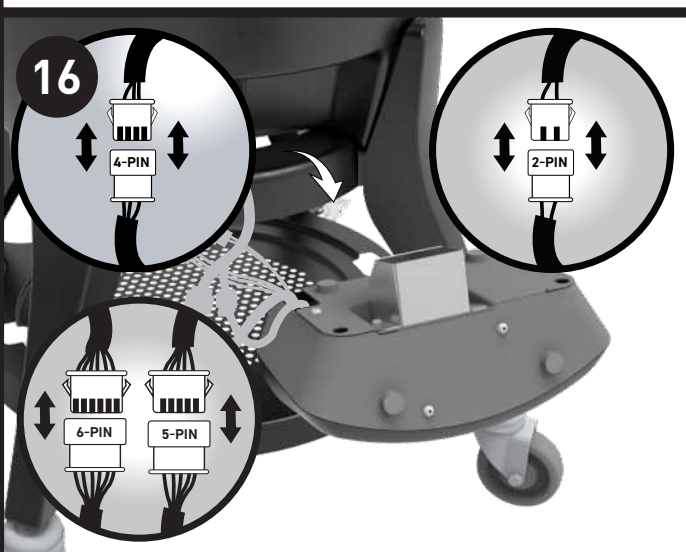

Disconnect the wire harness from the rear module. Use caution do not apply tension on the wire harness. Set the rear module aside, you will need to install this on the new black base kit.



Fish the new wire harness through the front pass through hole.

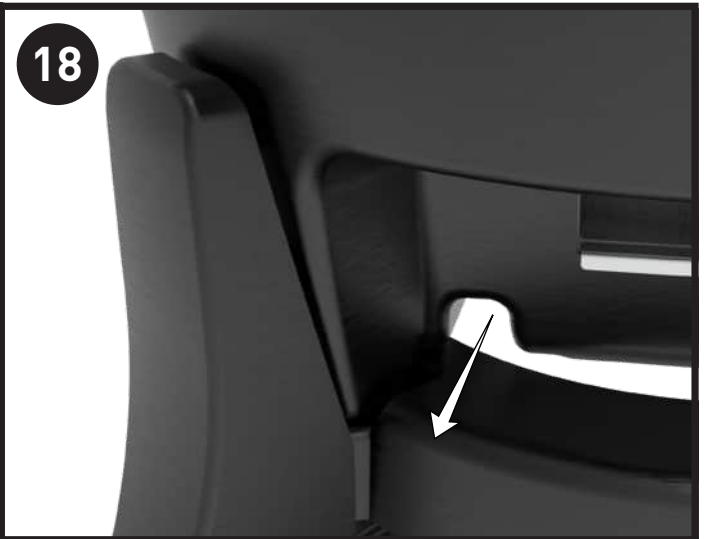

Fish the new wire harness through the rear pass through hole.



Remove the front and rear insulation.



Remove the firebox lower chamber.

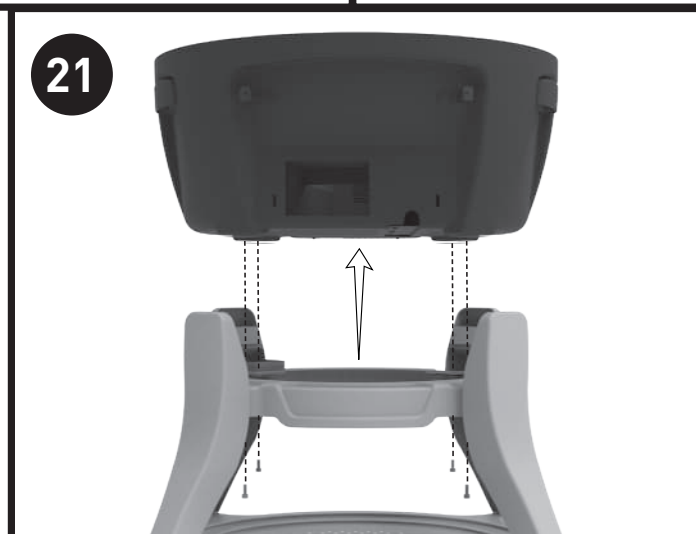

Remove the black base from the cart – remember to remove the 4 screws that connect the grill base to the cart.

Repeat the steps in reverse order to install the new Black Base Kit.